



5-year warranty



Technical data

| | | |
|---------------------------|---------------------------|--|
| Functional data | Valve Size | 2.5" [65] |
| | Fluid | chilled or hot water, up to 60% glycol |
| | Fluid Temp Range (water) | -22...250°F [-30...120°C] |
| | Body Pressure Rating | ANSI Class Grooved AWWA, 300 psi |
| | Flow characteristic | modified equal percentage |
| | Servicing | maintenance-free |
| | Rangeability Sv | 100:1 |
| | Flow Pattern | 2-way |
| | Leakage rate | 0% |
| | Controllable flow range | 90° rotation |
| | Cv | 260 |
| | ANSI Class | Grooved AWWA |
| | Body pressure rating note | 300 psi |
| | Maximum Velocity | 20 FPS |
| Materials | Valve body | Ductile cast iron ASTM A536 |
| | Body finish | black alkyd enamel |
| | Stem seal | fiberglass with TFE lining |
| | Seat | EPDM |
| | Pipe connection | grooved ANSI/AWWA (c606) |
| | Disc | electroless nickel coated ductile iron |
| Suitable actuators | Non-Spring | AMB(X) GRCB(X) GMB(X) |
| | Spring | AFB(X) |

Product features

Flow/Mounting details

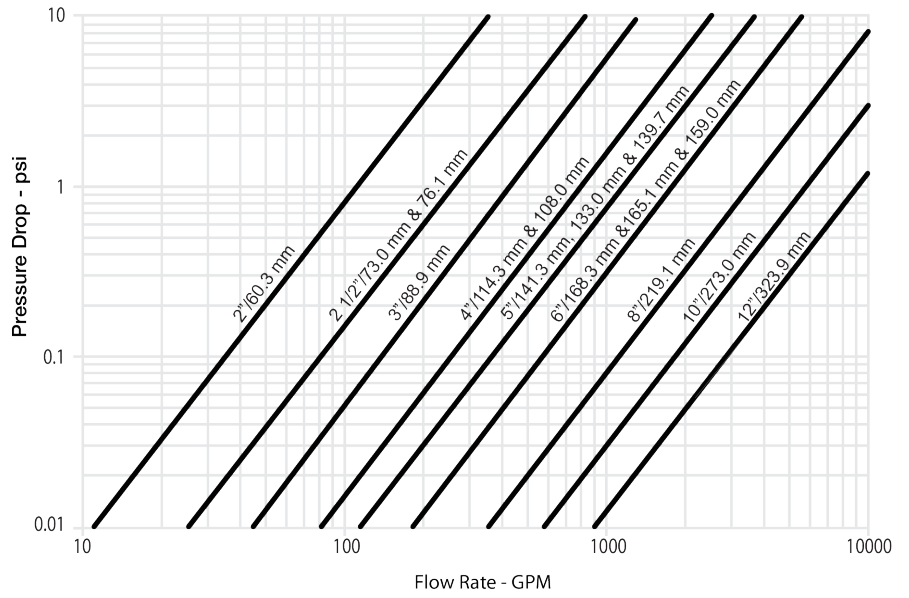

Dimensions

Dimensional drawings

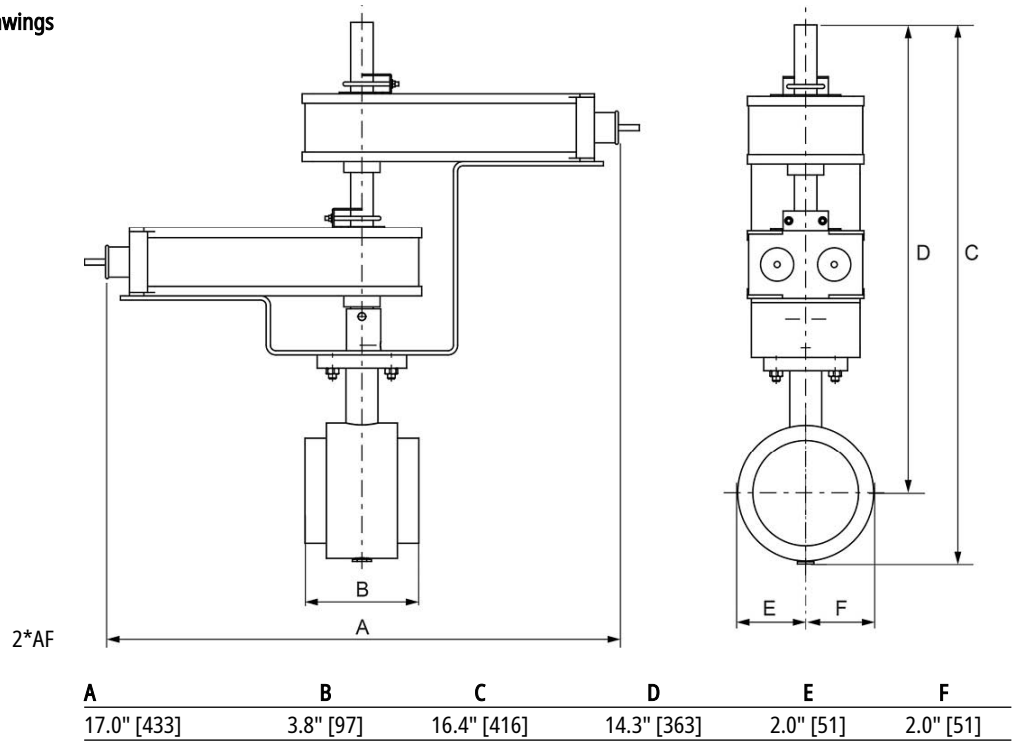

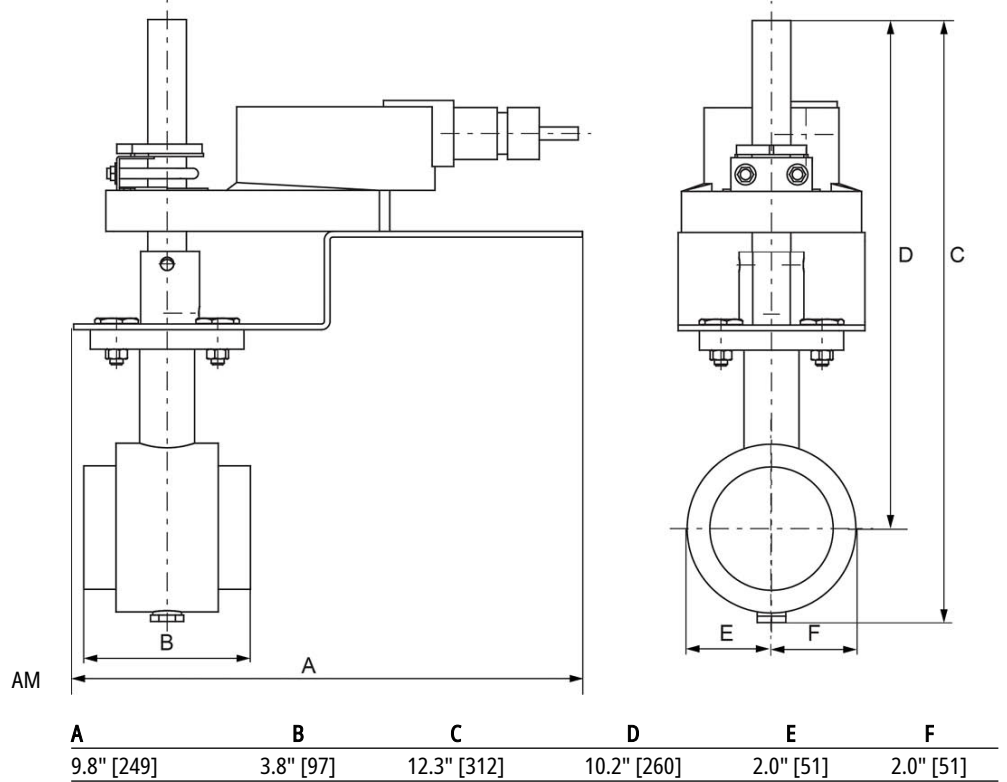
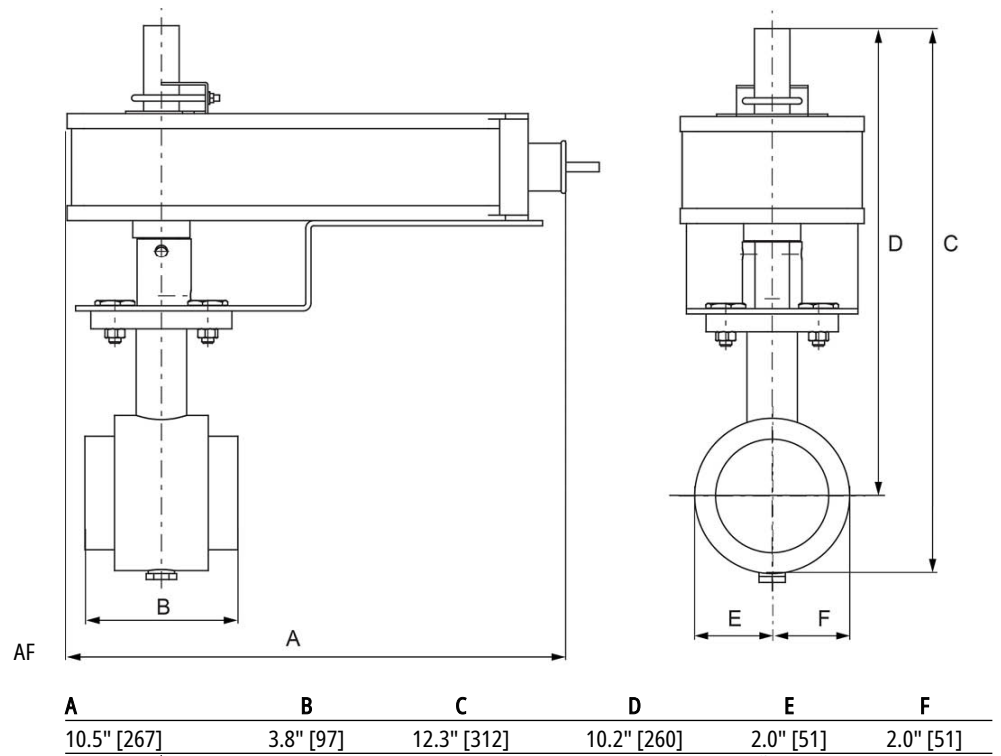

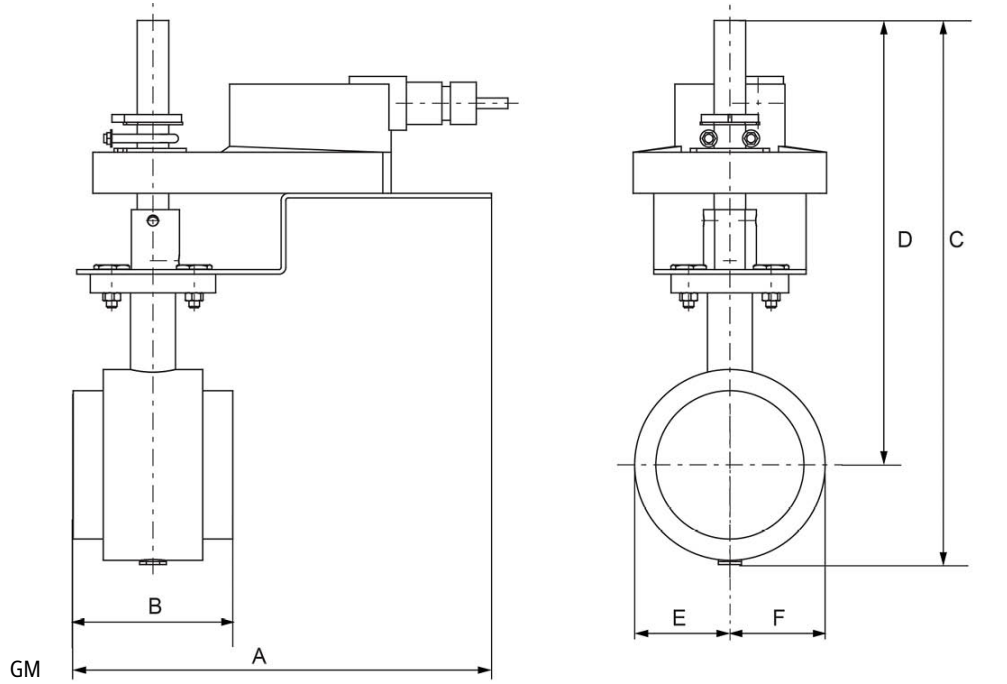

| A | B | C | D | E | F |
|------------|-----------|-------------|-------------|-----------|-----------|
| 9.9" [251] | 3.8" [97] | 12.3" [312] | 10.2" [260] | 2.0" [51] | 2.0" [51] |

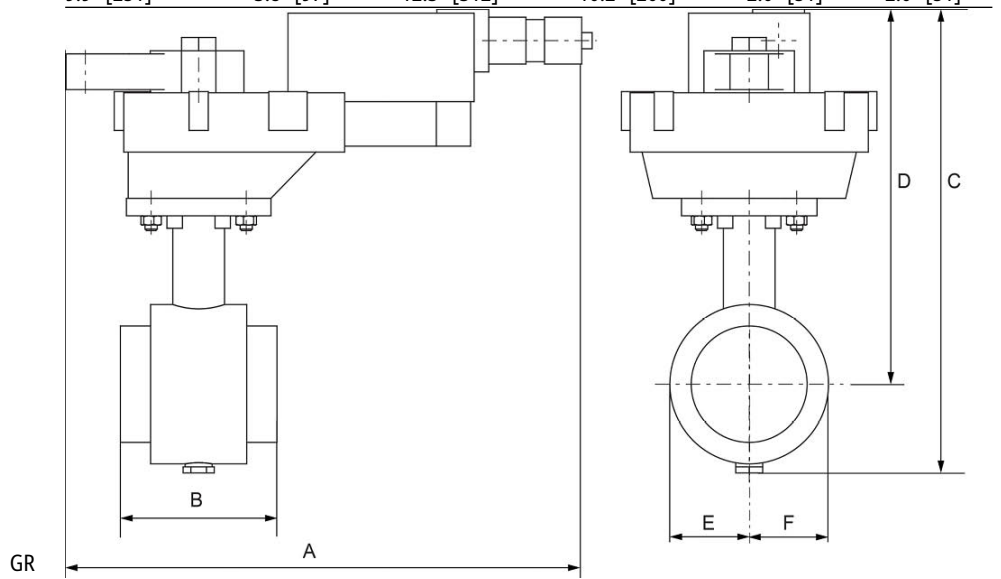

| A | B | C | D | E | F |
|-------------|-----------|-------------|------------|-----------|-----------|
| 10.8" [275] | 3.8" [97] | 10.2" [260] | 8.1" [206] | 2.0" [51] | 2.0" [51] |

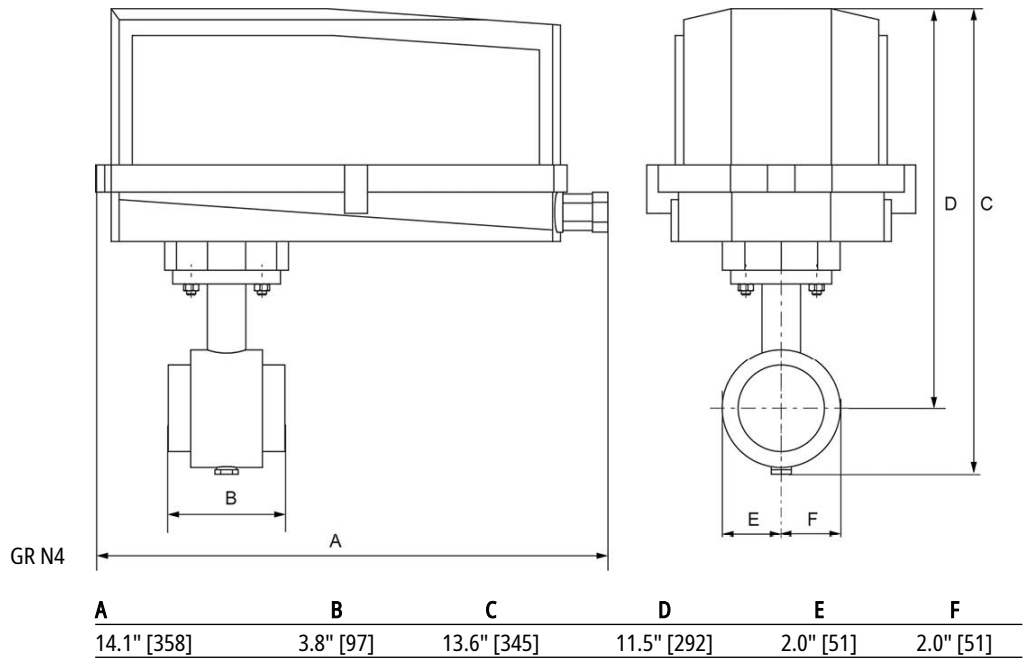



5-year warranty









Technical data

| | | |
|------------------------------|------------------------------------|--|
| Electrical data | Nominal voltage | AC 100...240 V |
| | Nominal voltage frequency | 50/60 Hz |
| | Power consumption in operation | 6 W |
| | Power consumption in rest position | 2 W |
| | Electrical Connection | 1/2" conduit connector, screw terminals |
| | Overload Protection | electronic throughout 0...95° rotation |
| Functional data | Input Impedance | 500 Ω |
| | Position feedback U | 2...10 V |
| | Position feedback U note | Max. 0.5 mA |
| | Direction of motion motor | selectable with switch 0/1 |
| | Manual override | external push button |
| | Angle of rotation | 90°, adjustable with mechanical stop |
| | Angle of rotation note | adjustable with mechanical stop |
| | Running Time (Motor) | 35 s, constant, independent of load |
| | Running time motor note | constant, independent of load |
| | Noise level, motor | 60 dB(A) |
| | Position indication | Mechanically, pluggable |
| | Safety data | Degree of protection IEC/EN |
| Degree of protection NEMA/UL | | NEMA 2 UL Enclosure Type 2 |
| Agency Listing | | cULus acc. to UL60730-1A/-2-14, CAN/CSA E60730-1:02, CE acc. to 2014/30/EU and 2014/35/EU; Listed to UL 2043 - suitable for use in air plenums per Section 300.22(c) of the NEC and Section 602.2 of the IMC |
| Quality Standard | | ISO 9001 |
| Ambient temperature | | -22...122°F [-30...50°C] |
| Storage temperature | | -40...176°F [-40...80°C] |
| Ambient humidity | | max. 95% r.H., non-condensing |
| Servicing | | maintenance-free |
| Weight | | Weight |
| Materials | Housing material | UL94-5VA |

Electrical installation

INSTALLATION NOTES

-  Provide overload protection and disconnect as required.
-  Actuators may be connected in parallel. Power consumption and input impedance must be observed.
-  Only connect common to negative (-) leg of control circuits.
-  A 500 Ω resistor (ZG-R01) converts the 4...20 mA control signal to 2...10 V.

-  Actuators are provided with a numbered screw terminal strip instead of a cable.
-  Meets cULus requirements without the need of an electrical ground connection.

 **Warning! Live electrical components!**

During installation, testing, servicing and troubleshooting of this product, it may be necessary to work with live electrical components. Have a qualified licensed electrician or other individual who has been properly trained in handling live electrical components perform these tasks. Failure to follow all electrical safety precautions when exposed to live electrical components could result in death or serious injury.

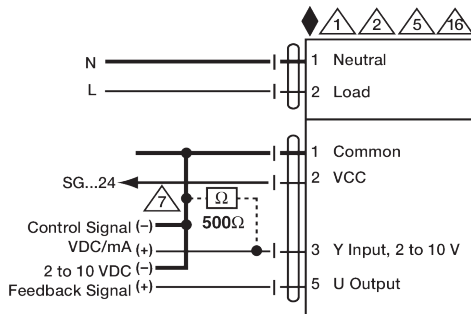

2...10 V / 4...20 mA Control AC 100...240 V