

Series 90

In-Line Mounted Centrifugal Pumps

Replacement Parts

Index

| | |
|---|----|
| How to Use This Parts List | 3 |
| Exploded Views of Series 90 | 4 |
| Standard Size Pump Designations | 5 |
| 1AA Pump Parts | 6 |
| 1 ¹ / ₄ AA Pump Parts | 7 |
| 1 ¹ / ₂ AA Pump Parts | 8 |
| 2AA Pump Parts | 9 |
| 1 ¹ / ₂ A Pump Parts | 10 |
| 2A Pump Parts | 11 |



How to use this PARTS LIST

The pump nameplate identifies the pump by pipe size, pump construction and impeller diameter as shown below.

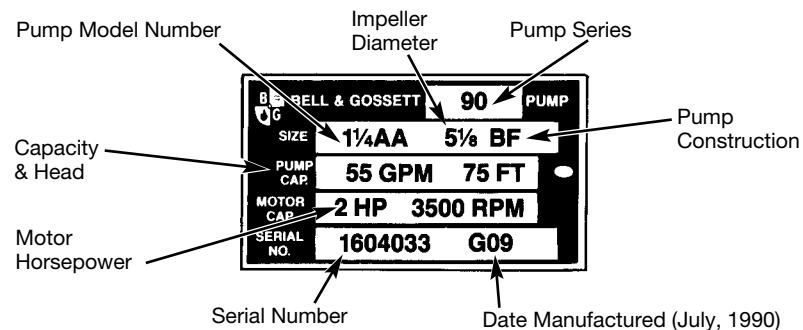

The nameplate above identifies the pump as a Series 90, 1¹/₄AA in bronze fitted (BF) construction. The impeller diameter is 5¹/₈" and is capable of pumping 55 GPM at 75 FT. The motor horsepower is 2, the RPM is 3500. The serial number specifically identifies the unit for future reference. **DO NOT REMOVE THE NAMEPLATE.** It is important when ordering replacement parts to furnish complete nameplate data.

The following procedure will result in proper parts selection:

1. Determine from the nameplate the pump size, pump construction and impeller diameter.
2. Measure the shaft diameter at the seal.
3. Refer to the index for the page number of the parts breakdown for the specific size pump.
4. Find the proper column in the parts breakdown for the pump construction involved.
5. Select part numbers, using the drawing on page 4 for identification. Where shaft diameter affects parts selection, use the measurement secured in step 2.
6. In some instances, motor brackets vary with motor frame sizes. Use the motor frame number from the motor nameplate to select the proper motor bracket. Always give complete motor nameplate data when ordering replacement motors.

Series 90 Pump Exploded View

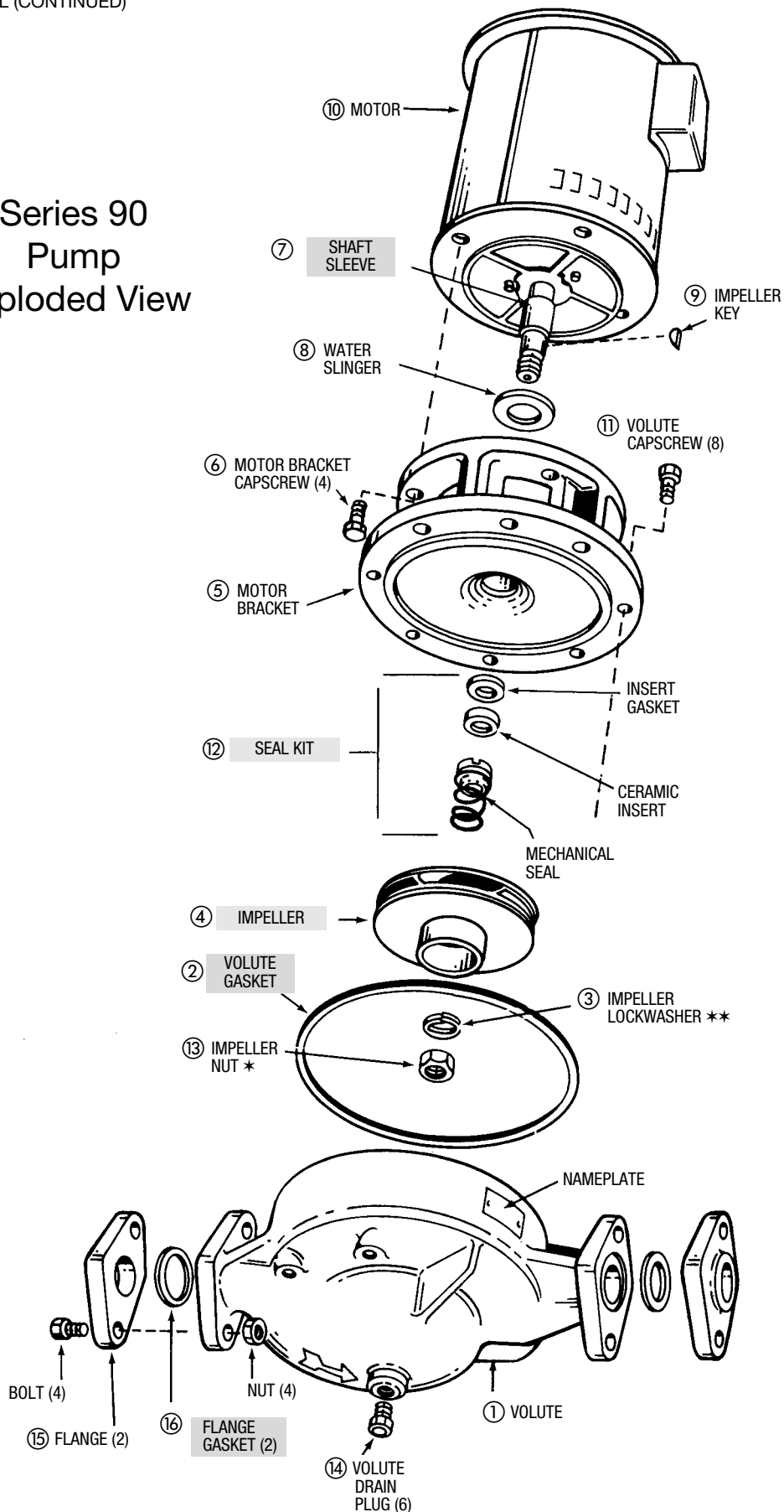

* — Impeller Capscrew on some 90 "A" Size Pumps.
 ■ — Factory recommended spare parts.

** — Impeller Gasket on All Bronze 90 "AA" Size Pumps.

STANDARD SIZE DESIGNATIONS

| PUMP SIZE | MODEL NUMBER | MOTOR ⑩ | HP | VOLTAGE | PH | RPM | FR | IMPELLER ④ | IMP. DIA. | SEAL KIT† ⑫ |
|-----------|--------------|------------|--------|-------------|---------|------|-------|---------------|-----------|----------------|
| 1 1/4"AA | 90-1S | 169067 | 1/2 | 115/230 | 1 | 3500 | 56 | P58251 | 37/16" | 118681LF |
| | 90-1T | 169213 | 1/2 | 208-230/460 | 3 | 3500 | 56 | P58251 | 37/16" | 118681LF |
| | 90-2S | 169068 | 3/4 | 115/230 | 1 | 3500 | 56 | P58280 | 4" | 118681LF |
| | 90-2T | 169214 | 3/4 | 208-230/460 | 3 | 3500 | 56 | P58280 | 4" | 118681LF |
| | 90-3S | 169069 | 1 | 115/230 | 1 | 3500 | 56 | P58252 | 4 3/8" | 118681LF |
| | 90-3T | 169215 | 1 | 208-230/460 | 3 | 3500 | 56 | P58252 | 4 3/8" | 118681LF |
| | 90-4S | 169216 | 1 1/2 | 115/230 | 1 | 3500 | 56 | P58253 | 5" | 186499LF |
| | 90-4T | 169217 | 1 1/2 | 208-230/460 | 3 | 3500 | 56 | P58253 | 5" | 186499LF |
| | 90-5T | 169218 | 2 | 208-230/460 | 3 | 3500 | 56 | P56610 | 5 1/4" | 186499LF |
| 1 1/2"AA | 90-6S | 169068 | 3/4 | 115/230 | 1 | 3500 | 56 | P56771 | 3 1/2" | 118681LF |
| | 90-6T | 169214 | 3/4 | 208-230/460 | 3 | 3500 | 56 | P56771 | 3 1/2" | 118681LF |
| | 90-7S | 169069 | 1 | 115/230 | 1 | 3500 | 56 | P56770 | 3 5/8" | 118681LF |
| | 90-7T | 169215 | 1 | 208-230/460 | 3 | 3500 | 56 | P56770 | 3 5/8" | 118681LF |
| | 90-8S | 169216 | 1 1/2 | 115/230 | 1 | 3500 | 56 | P56753 | 4" | 186499LF |
| | 90-8T | 169217 | 1 1/2 | 208-230/460 | 3 | 3500 | 56 | P56753 | 4" | 186499LF |
| | 90-9T | 169218 | 2 | 208-230/460 | 3 | 3500 | 56 | P56752 | 4 1/2" | 186499LF |
| | 90-10T | 169219 | 3 | 208-230/460 | 3 | 3500 | 56 | P56751 | 5" | 186499LF |
| | 2"AA | 90-11S | 169216 | 1 1/2 | 115/230 | 1 | 3500 | 56 | P58254 | 3 11/16" |
| 90-11T | | 169217 | 1 1/2 | 208-230/460 | 3 | 3500 | 56 | P58254 | 3 11/16" | 186499LF |
| 90-12T | | 169218 | 2 | 208-230/460 | 3 | 3500 | 56 | P56873 | 3 15/16" | 186499LF |
| 90-13T | | 169219 | 3 | 208-230/460 | 3 | 3500 | 56 | P56872 | 4 3/8" | 186499LF |
| 90-14T | | 169220 | 5 | 208-230/460 | 3 | 3500 | 56 | P56871 | 4 7/8" | 186499LF |
| 1 1/2"A | 90-15T | 169219 | 3 | 208-230/460 | 3 | 3500 | 56 | P57485 | 5 1/4" | 186499LF |
| | 90-16T | 169220 | 5 | 208-230/460 | 3 | 3500 | 56 | P57483 | 5 7/8" | 186499LF |
| | 90-17T | 188133 | 7 1/2 | 200 | 3 | 3500 | 184JM | P85574 | 6 5/8" | 186862LF |
| | 90-17T | 188131 | 7 1/2 | 208-230/460 | 3 | 3500 | 184JM | P85574 | 6 5/8" | 186862LF |
| | 90-18T | 188153 | 10 | 200 | 3 | 3500 | 213JM | P85456 | 7" | 186862LF |
| | 90-18T | 188152 | 10 | 208-230/460 | 3 | 3500 | 213JM | P85456 | 7" | 186862LF |
| 2"A | 90-19T | 188133 | 7 1/2 | 200 | 3 | 3500 | 184JM | P85580 | 5 3/4" | 186862LF |
| | 90-19T | 188131 | 7 1/2 | 208-230/460 | 3 | 3500 | 184JM | P85580 | 5 3/4" | 186862LF |
| | 90-20T | 188153 | 10 | 200 | 3 | 3500 | 213JM | P85579 | 6 1/2" | 186862LF |
| | 90-20T | 188152 | 10 | 208-230/460 | 3 | 3500 | 213JM | P85579 | 6 1/2" | 186862LF |
| | 90-21T | 188173 | 15 | 200 | 3 | 3500 | 215JM | P85578 | 7" | 186862LF |
| | 90-21T | 188172 | 15 | 208-230/460 | 3 | 3500 | 215JM | P85578 | 7" | 186862LF |
| 1 1/4"AA | 90-31S | 169200 | 1/4 | 115/230 | 1 | 1750 | 56 | P56560 | 5 1/8" | 118681LF |
| | 90-31T | 169201 | 1/4 | 208-230/460 | 3 | 1750 | 56 | P56560 | 5 1/8" | 118681LF |
| 1 1/2"AA | 90-33S | 169204 | 1/2 | 115/230 | 1 | 1750 | 56 | P56750 | 5 1/4" | 186499LF |
| | 90-33T | 169205 | 1/2 | 208-230/460 | 3 | 1750 | 56 | P56750 | 5 1/4" | 186499LF |
| 2"AA | 90-34S | 169206 | 3/4 | 115/230 | 1 | 1750 | 56 | P56870 | 5 1/4" | 186499LF |
| | 90-34T | 169207 | 3/4 | 208-230/460 | 3 | 1750 | 56 | P56870 | 5 1/4" | 186499LF |
| 1 1/2"A | 90-35S | 169204 | 1/2 | 115/230 | 1 | 1750 | 56 | P57481 | 5 3/4" | 186499LF |
| | 90-35T | 169205 | 1/2 | 208-230/460 | 3 | 1750 | 56 | P57481 | 5 3/4" | 186499LF |
| | 90-36S | 169206 | 3/4 | 115/230 | 1 | 1750 | 56 | P85581 | 6 3/8" | 186499LF |
| | 90-36T | 169207 | 3/4 | 208-230/460 | 3 | 1750 | 56 | P85581 | 6 3/8" | 186499LF |
| | 90-37S | 169208 | 1 | 115/230 | 1 | 1750 | 56 | P57441 | 7" | 186499LF |
| | 90-37T | 169209 | 1 | 208-230/460 | 3 | 1750 | 56 | P57441 | 7" | 186499LF |
| 2"A | 90-39S | 169208 | 1 | 115/230 | 1 | 1750 | 56 | P85586 | 6" | 186499LF |
| | 90-39T | 169209 | 1 | 208-230/460 | 3 | 1750 | 56 | P85586 | 6" | 186499LF |
| | 90-40S | 169210 | 1 1/2 | 115/230 | 1 | 1750 | 56 | P85585 | 6 1/2" | 186499LF |
| | 90-40T | 169211 | 1 1/2 | 208-230/460 | 3 | 1750 | 56 | P85585 | 6 1/2" | 186499LF |
| | 90-41T | 169212 | 2 | 208-230/460 | 3 | 1750 | 56 | P85584 | 7" | 186499LF |

†Buna/Carbon/Ceramic.

 - Factory recommended spare parts.

1AA

| ITEM NO. | DESCRIPTION | PUMP CONSTRUCTION | | |
|----------|-------------|-------------------|------------|--------------------------|
| | | BRONZE FITTED | ALL BRONZE | BRONZE FITTED W/EPT SEAL |

PARTS COMMON TO BOTH SIZE PUMPS

| | | | | |
|----|----------------------------|--------|----------|--------|
| 1 | Volute | P57041 | P2000031 | P57041 |
| 14 | Volute Drain Plug (6) | P39020 | P39470 | P39020 |
| 11 | Volute Capscrew (8) | P10359 | P10359 | P10359 |
| 2 | Volute Gasket | P57410 | P57410 | P57410 |
| 3 | Impeller Gasket | NONE | P57000 | NONE |
| 15 | Flange (2) | P01510 | P00836 | P01510 |
| 16 | Flange Gasket Set | 118368 | 118368 | 118368 |
| | Fastener Package | P64910 | P64900 | P64910 |
| 6 | Motor Bracket Capscrew (4) | DJ0063 | DJ0063 | DJ0063 |

PARTS FOR PUMPS WITH 1/2" SEAL (Determine Pump Seal Size from Motor Selection Chart Below)

| | | | | |
|----|---------------------------|----------|----------|----------|
| 4 | Impeller (State Diameter) | P56550 | P56550 | P56550 |
| 13 | Impeller Nut | P00651 | P2000236 | P00651 |
| 3 | Impeller Lockwasher | P04660 | NONE | P04660 |
| 9 | Impeller Key | P04945 | P04945 | P04945 |
| 8 | Water Slinger | P77335 | P77335 | P77335 |
| 12 | Seal – Std. ¹ | 118681LF | 118681LF | 185230LF |
| 12 | Seal – Opt. ² | 185382 | 185382 | 185382 |
| 7 | Shaft Sleeve | 186943LF | 186943LF | 186943LF |
| 5 | Motor Bracket | P62872 | P62874 | P62872 |

PARTS FOR PUMPS WITH 3/4" SEAL (Determine Pump Seal Size from Motor Selection Chart Below)

| | | | | |
|----|---------------------------|----------|----------|----------|
| 4 | Impeller (State Diameter) | P56610 | P56610 | P56610 |
| 13 | Impeller Nut | P59570 | P2000220 | P59570 |
| 3 | Impeller Lockwasher | P11220 | NONE | P11220 |
| 9 | Impeller Key | P51750 | P51750 | P51750 |
| 8 | Water Slinger | P81946 | P81946 | P81946 |
| 12 | Seal – Std. ¹ | 186499LF | 186499LF | 185223LF |
| 12 | Seal – Opt. ² | 186945 | 186945 | 186945 |
| 7 | Shaft Sleeve | 186944LF | 186944LF | 186944LF |
| 5 | Motor Bracket | P77067 | P62892 | P77067 |

¹Buna/Carbon/Ceramic ²EPR/SiC/SiC

| | |
|--|------------------------------------|
| | – Factory recommended spare parts. |
|--|------------------------------------|

MOTOR SELECTION CHART

| HP | 1 PHASE 1800 RPM | 3 PHASE 1800 RPM | SEAL SHAFT DIA. | 1 PHASE 3600 RPM | 3 PHASE 3600 RPM | SEAL SHAFT DIA. |
|----------|---------------------|---------------------|--------------------|---------------------|---------------------|--------------------|
| 1/4 HP | 169200 | 169201 | 1/2" | – | – | – |
| 1/3 HP | 169202 | 169203 | 1/2" | – | – | – |
| 1/2 HP | 169204 | 169205 | 3/4" | – | – | – |
| 3/4 HP | – | – | – | 169068 | 169214 | 1/2" |
| 1 HP | – | – | – | 169069 | 169215 | 1/2" |
| 1 1/2 HP | – | – | – | 169216 | 169217 | 3/4" |
| 2 HP | – | – | – | – | 169218 | 3/4" |

1 1/4 AA

| ITEM NO. | DESCRIPTION | PUMP CONSTRUCTION | | |
|----------|-------------|-------------------|------------|--------------------------|
| | | BRONZE FITTED | ALL BRONZE | BRONZE FITTED W/EPT SEAL |

PARTS COMMON TO BOTH SIZE PUMPS

| | | | | |
|----|----------------------------|--------|----------|--------|
| 1 | Volute | P57081 | P2000037 | P57081 |
| 14 | Volute Drain Plug (6) | P39020 | P39470 | P39020 |
| 11 | Volute Capscrew (8) | P10359 | P10359 | P10359 |
| 2 | Volute Gasket | P57410 | P57410 | P57410 |
| 3 | Impeller Gasket | NONE | P57000 | NONE |
| 15 | Flange (2) | P03250 | P00837 | P03250 |
| 16 | Flange Gasket Set | 118368 | 118368 | 118368 |
| | Fastener Package | P64910 | P64900 | P64910 |
| 6 | Motor Bracket Capscrew (4) | DJ0063 | DJ0063 | DJ0063 |

PARTS FOR PUMPS WITH 1/2" SEAL (Determine Pump Seal Size from Motor Selection Chart Below)

| | | | | |
|----|---------------------------|----------|----------|----------|
| 4 | Impeller (State Diameter) | P56550 | P56550 | P56550 |
| 13 | Impeller Nut | P00651 | P2000236 | P00651 |
| 3 | Impeller Lockwasher | P04660 | NONE | P04660 |
| 9 | Impeller Key | P04945 | P04945 | P04945 |
| 8 | Water Slinger | P77335 | P77335 | P77335 |
| 12 | Seal – Std. ¹ | 118681LF | 118681LF | 185230LF |
| 12 | Seal – Opt. ² | 185382 | 185382 | 185382 |
| 7 | Shaft Sleeve | 186943LF | 186943LF | 186943LF |
| 5 | Motor Bracket | P62872 | P62874 | P62872 |

PARTS FOR PUMPS WITH 3/4" SEAL (Determine Pump Seal Size from Motor Selection Chart Below)

| | | | | |
|----|---------------------------|----------|----------|----------|
| 4 | Impeller (State Diameter) | P56610 | P56610 | P56610 |
| 13 | Impeller Nut | P59570 | P2000220 | P59570 |
| 3 | Impeller Lockwasher | P11220 | NONE | P11220 |
| 9 | Impeller Key | P51750 | P51750 | P51750 |
| 8 | Water Slinger | P81946 | P81946 | P81946 |
| 12 | Seal – Std. ¹ | 186499LF | 186499LF | 185223LF |
| 12 | Seal – Opt. ² | 186945 | 186945 | 186945 |
| 7 | Shaft Sleeve | 186944LF | 186944LF | 186944LF |
| 5 | Motor Bracket | P77067 | P62892 | P77067 |

¹Buna/Carbon/Ceramic ²EPR/SiC/SiC

| | |
|--|------------------------------------|
| | – Factory recommended spare parts. |
|--|------------------------------------|

MOTOR SELECTION CHART

| HP | 1 PHASE 1800 RPM | 3 PHASE 1800 RPM | SEAL SHAFT DIA. | 1 PHASE 3600 RPM | 3 PHASE 3600 RPM | SEAL SHAFT DIA. |
|----------|---------------------|---------------------|--------------------|---------------------|---------------------|--------------------|
| 1/4 HP | 169200 | 169201 | 1/2" | – | – | – |
| 1/3 HP | 169202 | 169203 | 1/2" | – | – | – |
| 1/2 HP | 169204 | 169205 | 3/4" | 169067 | 169213 | 1/2" |
| 3/4 HP | – | – | – | 169068 | 169214 | 1/2" |
| 1 HP | – | – | – | 169069 | 169215 | 1/2" |
| 1 1/2 HP | – | – | – | 169216 | 169217 | 3/4" |
| 2 HP | – | – | – | – | 169218 | 3/4" |
| 3 HP | – | – | – | – | 169219 | 3/4" |

1 1/2 AA

| ITEM NO. | DESCRIPTION | PUMP CONSTRUCTION | | |
|----------|-------------|-------------------|------------|--------------------------|
| | | BRONZE FITTED | ALL BRONZE | BRONZE FITTED W/EPT SEAL |

PARTS COMMON TO BOTH SIZE PUMPS

| | | | | |
|----|----------------------------|--------|----------|--------|
| 1 | Volute | P57151 | P2000040 | P57151 |
| 14 | Volute Drain Plug (6) | P39020 | P39470 | P39020 |
| 11 | Volute Capscrew (8) | P10359 | P10359 | P10359 |
| 2 | Volute Gasket | P57410 | P57410 | P57410 |
| 3 | Impeller Gasket | NONE | P57000 | NONE |
| 15 | Flange (2) | P03410 | P2000090 | P03410 |
| 16 | Flange Gasket Set | 118373 | 118373 | 118373 |
| | Fastener Package | P64940 | P64930 | P64940 |
| 6 | Motor Bracket Capscrew (4) | DJ0063 | DJ0063 | DJ0063 |

PARTS FOR PUMPS WITH 1/2" SEAL (Determine Pump Seal Size from Motor Selection Chart Below)

| | | | | |
|----|---------------------------|----------|----------|----------|
| 4 | Impeller (State Diameter) | P56740 | P56740 | P56740 |
| 13 | Impeller Nut | P00651 | P2000236 | P00651 |
| 3 | Impeller Lockwasher | P04660 | NONE | P04660 |
| 9 | Impeller Key | P04945 | P04945 | P04945 |
| 8 | Water Slinger | P77335 | P77335 | P77335 |
| 12 | Seal – Std. ¹ | 118681LF | 118681LF | 185230LF |
| 12 | Seal – Opt. ² | 185382 | 185382 | 185382 |
| 7 | Shaft Sleeve | 186943LF | 186943LF | 186943LF |
| 5 | Motor Bracket | P62872 | P62874 | P62872 |

PARTS FOR PUMPS WITH 3/4" SEAL (Determine Pump Seal Size from Motor Selection Chart Below)

| | | | | |
|----|---------------------------|----------|----------|----------|
| 4 | Impeller (State Diameter) | P56750 | P56750 | P56750 |
| 13 | Impeller Nut | P59570 | P2000220 | P59570 |
| 3 | Impeller Lockwasher | P11220 | NONE | P11220 |
| 9 | Impeller Key | P51750 | P51750 | P51750 |
| 8 | Water Slinger | P81946 | P81946 | P81946 |
| 12 | Seal – Std. ¹ | 186499LF | 186499LF | 185223LF |
| 12 | Seal – Opt. ² | 186945 | 186945 | 186945 |
| 7 | Shaft Sleeve | 186944LF | 186944LF | 186944LF |
| 5 | Motor Bracket | P77067 | P62892 | P77067 |

¹Buna/Carbon/Ceramic ²EPR/SiC/SiC

– Factory recommended spare parts.

MOTOR SELECTION CHART

| HP | 1 PHASE 1800 RPM | 3 PHASE 1800 RPM | SEAL SHAFT DIA. | 1 PHASE 3600 RPM | 3 PHASE 3600 RPM | SEAL SHAFT DIA. |
|----------|---------------------|---------------------|--------------------|---------------------|---------------------|--------------------|
| 1/4 HP | 169200 | 169201 | 1/2" | – | – | – |
| 1/3 HP | 169202 | 169203 | 1/2" | – | – | – |
| 1/2 HP | 169204 | 169205 | 3/4" | – | – | – |
| 3/4 HP | 169206 | 169207 | 3/4" | 169068 | 169214 | 1/2" |
| 1 HP | – | – | – | 169069 | 169215 | 1/2" |
| 1 1/2 HP | – | – | – | 169216 | 169217 | 3/4" |
| 2 HP | – | – | – | – | 169218 | 3/4" |
| 3 HP | – | – | – | – | 169219 | 3/4" |
| 5 HP | – | – | – | – | 169220 | 3/4" |

2AA

| ITEM NO. | DESCRIPTION | PUMP CONSTRUCTION | | |
|----------|-------------|-------------------|------------|--------------------------|
| | | BRONZE FITTED | ALL BRONZE | BRONZE FITTED W/EPT SEAL |

PARTS COMMON TO BOTH SIZE PUMPS

| | | | | |
|----|----------------------------|--------|----------|--------|
| 1 | Volute | P57221 | P2000043 | P57221 |
| 14 | Volute Drain Plug (6) | P39020 | P39470 | P39020 |
| 11 | Volute Capscrew (8) | P10359 | P10359 | P10359 |
| 2 | Volute Gasket | P57410 | P57410 | P57410 |
| 3 | Impeller Gasket | NONE | P57000 | NONE |
| 15 | Flange (2) | F14200 | P2000078 | F14200 |
| 16 | Flange Gasket Set | 118378 | 118378 | 118378 |
| | Fastener Package | P65031 | P65030 | P65031 |
| 6 | Motor Bracket Capscrew (4) | DJ0063 | DJ0063 | DJ0063 |

PARTS FOR PUMPS WITH 1/2" SEAL (Determine Pump Seal Size from Motor Selection Chart Below)

| | | | | |
|----|---------------------------|----------|----------|----------|
| 4 | Impeller (State Diameter) | P56830 | P56830 | P56830 |
| 13 | Impeller Nut | P00651 | P2000236 | P00651 |
| 3 | Impeller Lockwasher | P04660 | NONE | P04660 |
| 9 | Impeller Key | P04945 | P04945 | P04945 |
| 8 | Water Slinger | P77335 | P77335 | P77335 |
| 12 | Seal – Std. ¹ | 118681LF | 118681LF | 185230LF |
| 12 | Seal – Opt. ² | 185382 | 185382 | 185382 |
| 7 | Shaft Sleeve | 186943LF | 186943LF | 186943LF |
| 5 | Motor Bracket | P62872 | P62874 | P62872 |

PARTS FOR PUMPS WITH 3/4" SEAL (Determine Pump Seal Size from Motor Selection Chart Below)

| | | | | |
|----|---------------------------|----------|----------|----------|
| 4 | Impeller (State Diameter) | P56870 | P56870 | P56870 |
| 13 | Impeller Nut | P59570 | P2000220 | P59570 |
| 3 | Impeller Lockwasher | P11220 | NONE | P11220 |
| 9 | Impeller Key | P51750 | P51750 | P51750 |
| 8 | Water Slinger | P81946 | P81946 | P81946 |
| 12 | Seal – Std. ¹ | 186499LF | 186499LF | 185223LF |
| 12 | Seal – Opt. ² | 186945 | 186945 | 186945 |
| 7 | Shaft Sleeve | 186944LF | 186944LF | 186944LF |
| 5 | Motor Bracket | P77067 | P62892 | P77067 |

¹Buna/Carbon/Ceramic ²EPR/SiC/SiC

| | |
|--|------------------------------------|
| | – Factory recommended spare parts. |
|--|------------------------------------|

MOTOR SELECTION CHART

| HP | 1 PHASE 1800 RPM | 3 PHASE 1800 RPM | SEAL SHAFT DIA. | 1 PHASE 3600 RPM | 3 PHASE 3600 RPM | SEAL SHAFT DIA. |
|----------|---------------------|---------------------|--------------------|---------------------|---------------------|--------------------|
| 1/4 HP | 169200 | 169201 | 1/2" | – | – | – |
| 1/3 HP | 169202 | 169203 | 1/2" | – | – | – |
| 1/2 HP | 169204 | 169205 | 3/4" | – | – | – |
| 3/4 HP | 169206 | 169207 | 3/4" | – | – | – |
| 1 HP | 169208 | 169209 | 3/4" | – | – | – |
| 1 1/2 HP | – | – | – | 169216 | 169217 | 3/4" |
| 2 HP | – | – | – | – | 169218 | 3/4" |
| 3 HP | – | – | – | – | 169219 | 3/4" |
| 5 HP | – | – | – | – | 169220 | 3/4" |

1 1/2 A

| ITEM NO. | DESCRIPTION | PUMP CONSTRUCTION | | |
|----------|-------------|-------------------|------------|--------------------------|
| | | BRONZE FITTED | ALL BRONZE | BRONZE FITTED W/EPT SEAL |

PARTS COMMON TO BOTH SIZE PUMPS

| | | | | |
|----|-----------------------|--------|----------|--------|
| 1 | Volute | P57181 | P2000046 | P57181 |
| 14 | Volute Drain Plug (6) | P39020 | P39470 | P39020 |
| 11 | Volute Capscrew (8) | P40020 | P40020 | P40020 |
| 2 | Volute Gasket | P57700 | P57700 | P57700 |
| 15 | Flange (2) | P03410 | P2000090 | P03410 |
| 16 | Flange Gasket Set | 118373 | 118373 | 118373 |
| | Fastener Package | P64940 | P64930 | P64940 |

PARTS FOR PUMPS WITH 3/4" SEAL (Determine Pump Seal Size from Motor Selection Chart Below)

| | | | | |
|----|--------------------------------------|----------|----------|----------|
| 4 | Impeller (State Diameter) | P57441 | P57441 | P57441 |
| 13 | Impeller Nut | P59570 | P2000220 | P59570 |
| 3 | Impeller Lockwasher | P11220 | P11220 | P11220 |
| 9 | Impeller Key | P51750 | P51750 | P51750 |
| 8 | Water Slinger | P81946 | P81946 | P81946 |
| 12 | Seal – Std. ¹ | 186499LF | 186499LF | 185223LF |
| 12 | Seal – Opt. ² | 186945 | 186945 | 186945 |
| 7 | Shaft Sleeve | 186944LF | 186944LF | 186944LF |
| 5 | Motor Bracket | P62876 | P62878 | P62876 |
| 6 | Motor Bracket Capscrew (4) for above | P40020 | P40020 | P40020 |

PARTS FOR PUMPS WITH 1 1/4" SEAL (Determine Pump Seal Size from Motor Selection Chart Below)

| | | | | |
|----|--|----------|-------------|----------|
| 4 | Impeller (State Diameter) | P85456 | NOT OFFERED | P85456 |
| | Impeller Capscrew | P52350 | | P52350 |
| 3 | Impeller Lockwasher | J23874 | | J23874 |
| 9 | Impeller Key | P49369 | | P49369 |
| 8 | Water Slinger | P53550 | | P53550 |
| 12 | Seal – Std. ¹ | 186862LF | | 186861LF |
| 12 | Seal – Opt. ² | P75423 | | P75423 |
| 7 | Shaft Sleeve | 185024LF | | 185024LF |
| 5 | Motor Bracket - Motor Frame 184JM | P62882 | | P62882 |
| 6 | Motor Bracket Capscrew (4) for above | P40020 | | P40020 |
| 5 | Motor Bracket - Motor Frames 213JM-215JM | P62886 | P62886 | |
| 6 | Motor Bracket Capscrew (4) for above | K03600 | K03600 | |

¹Buna/Carbon/Ceramic ²EPR/SiC/SiC

| | |
|--|------------------------------------|
| | – Factory recommended spare parts. |
|--|------------------------------------|

MOTOR SELECTION CHART

| HP | 1 PHASE 1800 RPM | 3 PHASE 1800 RPM | SEAL SHAFT DIA. | 1 PHASE 3600 RPM | 3 PHASE 3600 RPM | SEAL SHAFT DIA. |
|----------|---------------------|---------------------|--------------------|---------------------|---------------------|--------------------|
| 1/2 HP | 169204 | 169205 | 3/4" | – | – | – |
| 3/4 HP | 169206 | 169207 | 3/4" | – | – | – |
| 1 HP | 169208 | 169209 | 3/4" | – | – | – |
| 1 1/2 HP | 169210 | 169210 | 3/4" | – | – | – |
| 2 HP | – | – | – | – | – | – |
| 3 HP | – | – | – | – | 169219 | 3/4" |
| 5 HP | – | – | – | – | 169220 | 3/4" |
| 7 1/2 HP | – | – | – | – | 188131+ | 1 1/4" |
| 10 HP | – | – | – | – | 188152++ | 1 1/4" |

+ For 200V only use 188133

++ For 200V only use 188153

2A

| ITEM NO. | DESCRIPTION | PUMP CONSTRUCTION | | |
|----------|-------------|-------------------|------------|--------------------------|
| | | BRONZE FITTED | ALL BRONZE | BRONZE FITTED W/EPT SEAL |

PARTS COMMON TO BOTH SIZE PUMPS

| | | | | |
|----|-----------------------|--------|----------|--------|
| 1 | Volute | P57278 | P2000049 | P57278 |
| 14 | Volute Drain Plug (6) | P39020 | P39470 | P39020 |
| 11 | Volute Capscrew (8) | P40020 | P40020 | P40020 |
| 2 | Volute Gasket | P57700 | P57700 | P57700 |
| 15 | Flange (2) | F14200 | P2000078 | F14200 |
| 16 | Flange Gasket Set | 118378 | 118378 | 118378 |
| | Fastener Package | P65031 | P65030 | P65031 |

PARTS FOR PUMPS WITH 3/4" SEAL (Determine Pump Seal Size from Motor Selection Chart Below)

| | | | | |
|----|--------------------------------------|----------|----------|----------|
| 4 | Impeller (State Diameter) | P85584 | P85584 | P85584 |
| 13 | Impeller Nut | P59570 | P2000220 | P59570 |
| 3 | Impeller Lockwasher | P11220 | P11220 | P11220 |
| 9 | Impeller Key | P51750 | P51750 | P51750 |
| 8 | Water Slinger | P81946 | P81946 | P81946 |
| 12 | Seal – Std. ¹ | 186499LF | 186499LF | 185223LF |
| 12 | Seal – Opt. ² | 186945 | 186945 | 186945 |
| 7 | Shaft Sleeve | 186944LF | 186944LF | 186944LF |
| 5 | Motor Bracket | P62876 | P62878 | P62876 |
| 6 | Motor Bracket Capscrew (4) for above | P40020 | P40020 | P40020 |

PARTS FOR PUMPS WITH 1 1/4" SEAL (Determine Pump Seal Size from Motor Selection Chart Below)

| | | | | |
|----|--|----------|-------------|----------|
| 4 | Impeller (State Diameter) | P85578 | NOT OFFERED | P85578 |
| | Impeller Capscrew | P52350 | | P52350 |
| 3 | Impeller Lockwasher | J23874 | | J23874 |
| 9 | Impeller Key | P49369 | | P49369 |
| 8 | Water Slinger | P53550 | | P53550 |
| 12 | Seal – Std. ¹ | 186862LF | | 186861LF |
| 12 | Seal – Opt. ² | P75423 | | P75423 |
| 7 | Shaft Sleeve | 185024LF | | 185024LF |
| 5 | Motor Bracket - Motor Frame 184JM | P62882 | | P62882 |
| 6 | Motor Bracket Capscrew (4) for above | P40020 | | P40020 |
| 5 | Motor Bracket - Motor Frames 213JM-215JM | P62886 | P62886 | |
| 6 | Motor Bracket Capscrew (4) for above | K03600 | K03600 | |

¹Buna/Carbon/Ceramic ²EPR/SiC/SiC

| | |
|--|------------------------------------|
| | – Factory recommended spare parts. |
|--|------------------------------------|

MOTOR SELECTION CHART

| HP | 1 PHASE 1800 RPM | 3 PHASE 1800 RPM | SEAL SHAFT DIA. | 1 PHASE 3600 RPM | 3 PHASE 3600 RPM | SEAL SHAFT DIA. |
|----------|---------------------|---------------------|--------------------|---------------------|---------------------|--------------------|
| 3/4 HP | 169206 | 169207 | 3/4" | – | – | – |
| 1 HP | 169208 | 169209 | 3/4" | – | – | – |
| 1 1/2 HP | 169210 | 169210 | 3/4" | – | – | – |
| 2 HP | – | 169212 | 3/4" | – | – | – |
| 3 HP | – | – | – | – | 169219 | 3/4" |
| 5 HP | – | – | – | – | 169220 | 3/4" |
| 7 1/2 HP | – | – | – | – | 188131+ | 1 1/4" |
| 10 HP | – | – | – | – | 188152++ | 1 1/4" |
| 15 HP | – | – | – | – | 188172* | 1 1/4" |

+ For 200V only use 188133

++ For 200V only use 188153

*For 200V only use 188173

Xylem |'zīləm|

- 1) The tissue in plants that brings water upward from the roots;
- 2) a leading global water technology company.

We're 12,700 people unified in a common purpose: creating innovative solutions to meet our world's water needs. Developing new technologies that will improve the way water is used, conserved, and re-used in the future is central to our work. We move, treat, analyze, and return water to the environment, and we help people use water efficiently, in their homes, buildings, factories and farms. In more than 150 countries, we have strong, long-standing relationships with customers who know us for our powerful combination of leading product brands and applications expertise, backed by a legacy of innovation.

For more information on how Xylem can help you, go to www.xylem.com



Xylem Inc.
8200 N. Austin Avenue
Morton Grove, Illinois 60053
Phone: (847) 966-3700
Fax: (847) 965-8379
www.bellgossett.com

Bell & Gossett is a trademark of Xylem Inc. or one of its subsidiaries.
© 2013 Xylem Inc. CP-112H-PL July 2010