

FIP X FIP • FORGED BRASS BODY

Features

- Forged Brass Body
- PTFE ball seats
- Blow out proof brass stem
- Aluminum Alloy Yellow Handle

Specifications & Approvals

Max Pressure Rating: 250 psi WOG
 Temperature Range: -4°F to 149°F
 600 psi WOG 175 psi WSP
 Thread Ends Conform to ANSI B1.20.1
 CSA Approved Per: ANSI Z21.15 / CSA 9.1(1/2psi)
 ASME B16.44 / CR91-002(5psi)
 ASME B16.33 / CGA3.16 (175psi)
 UL Listed per: UL 125 (Guide YSDT) 125 WOG

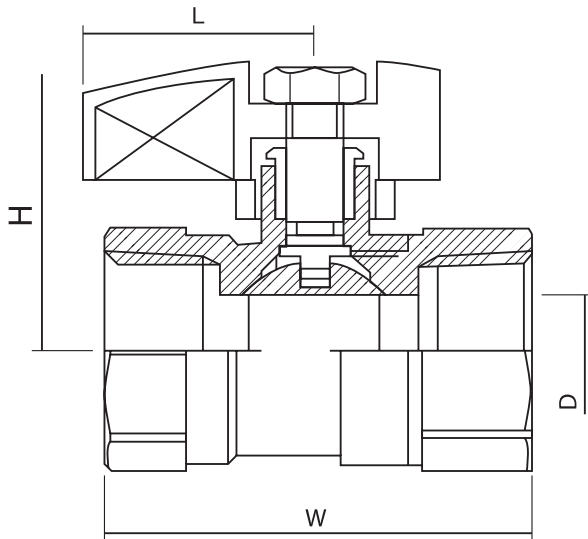
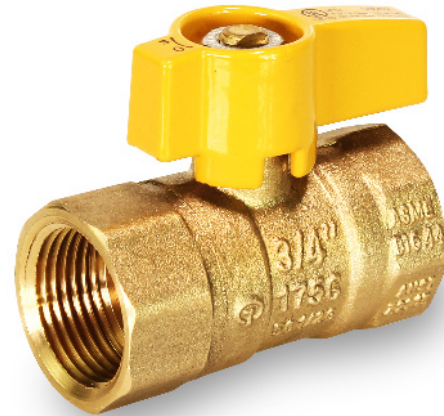

Dimensions

Part#	Size	D	L	H	W
4512Y	1/2"	0.394	1.28	1.44	2.204
4534Y	3/4"	0.591	1.28	1.54	2.362

Material Specifications

Part Name	Material
Body	Brass
Seat	PTFE
Ball	Chrome Plated
O-Ring	NBR
Packing Nut	Brass
Stem	Brass
Lock Nut	Ferrum / Plated Copper
Ball Packing	PTFE
Handle	Al Alloy
Cap	Brass