

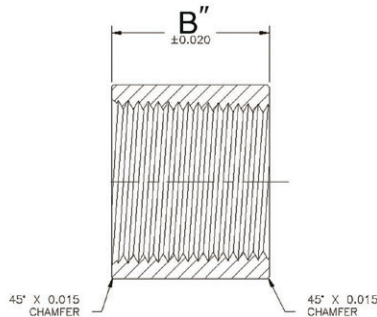

SPECIFICATIONS

- Meets or exceeds all applicable ASTM, ANSI and API standards
- Merchant Couplings stocked 1/8" - 6" diameters
- API Line Couplings stocked 1/8" - 8" diameters
- Full stock of specialty couplings, such as Half Couplings and Right and Left Couplings
- WOG (PSI) 300 at 150°F
- Saturated Steam Pressure 150 PSI

Nom. Diam. in Inches	1/8"	1/4"	3/8"	1/2"	3/4"	1"	1-1/4"	1-1/2"	2"	2-1/2"	3"	4"	5"	6"
Standard Merchant Coupling														
O.D. In.	0.563	0.719	0.875	1.063	1.313	1.576	1.900	2.200	2.750	3.250	4.000	5.000	6.296	7.390
Length In.	13/16	1-3/16	1-3/16	1-9/16	1-5/8	2	2-1/16	2-1/16	2-1/18	3-1/8	3-1/4	3-1/2	3-3/4	4
Half Coupling														
O.D. In.	0.563	0.719	0.875	1.063	1.313	1.576	1.900	2.200	2.750	-	-	-	-	-
Length In.	11/32	17/32	17/32	23/32	3/4	15/16	31/32	31/32	1	-	-	-	-	-
API Coupling														
O.D. In.	0.563	0.719	0.875	1.063	1.313	1.660	2.054	2.200	2.875	3.375	4.000	5.000	6.296	7.390
Length In.	1-1/16	1-5/8	1-5/8	2-1/8	2-1/8	2-5/8	2-3/4	2-3/4	2-7/8	4-1/8	4-1/4	4-1/2	4-5/8	4-7/8

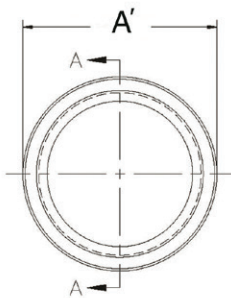

size	"A"/in	"B"/in	Threads/in	Threads
1/8	0.563	3/4	27	NPSL
1/4	0.719	1-1/8	18	NPSL
3/8	0.875	1-1/8	18	NPSL
1/2	1.063	1-1/2	14	NPSL
3/4	1.313	1-9/16	14	NPSL
1	1.576	1-15/16	11.5	NPSL
1-1/4	1.900	2	11.5	NPSL
1-1/2	2.200	2	11.5	NPSL
2	2.750	2-1/16	11.5	NPSL
2-1/2	3.250	3-1/16	8	NPT
3	4.000	3-3/16	8	NPT
3-1/2	4.625	3-5/16	8	NPT
4	5.000	3-7/16	8	NPT
5	6.296	3-11/16	8	NPT
6	7.390	3-15/16	8	NPT