

BREATHER VENT INSTALLATION



TYPE 1, 3, 3R, 3S, 4, 4X & 12

SCE-BVK

CAN BE INSTALLED ON ANY SURFACE
WITH EXCEPTION OF THE ENCLOSURE TOP

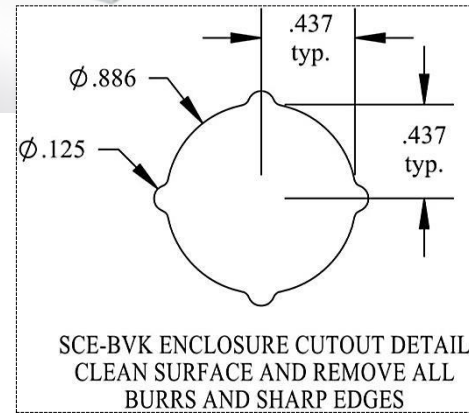

Standard .866" (22mm) push button cutout

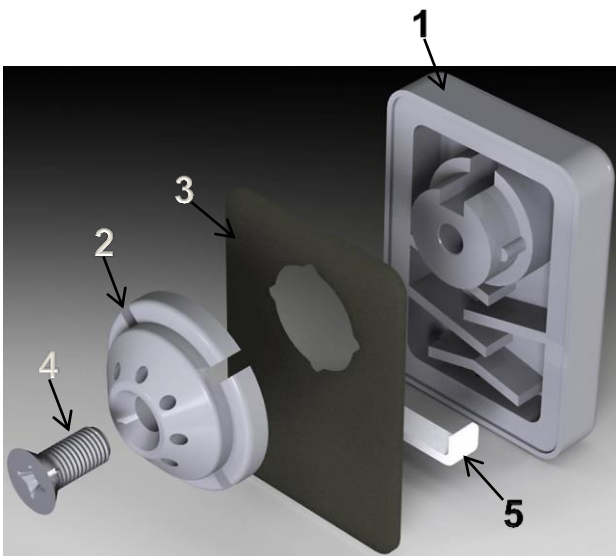

TORQUE TO
10 IN-LB

ITEM	QTY	PART DESCRIPTION
1	1	BREATHER / VENT
2	1	BREATHER / VENT CAP
3	1	GASKET, VNN MATERIAL W/ ADHESIVE BACK
4	1	SCREW, FLAT HEAD PHILLIPS, 1/4-20 X 3/4, STEEL ZINC
5	1	FILTER, 0.33 x 1.25 x 0.25, REGICELL POLYESTER FOAM